

## JSD-CP SERIES GAS STATION CANOPY



### PRODUCT DESCRIPTION

The JSD-CP Series Gas Station Canopy light can be widely used in indoor or outdoor lighting (wet location rated.) Excellent for gas stations, shopping malls, parking garages, and many more applications.

### FEATURES

- LED high luminous efficiency and long working life
- High efficiency LED Driver, the wide range input voltage AC120-277V
- Die-cast aluminum vented design for thermal control, high quality and better cooling for LED junction temperature,  $T_j < 58^{\circ}\text{C}$
- Excellent optical design greatly improves light utilization and uniformity
- Motion sensor control available (Optional)
- Sealed against moisture and environmental contaminants (IP65)

### PERFORMANCE SUMMARY

|                         |                                      |
|-------------------------|--------------------------------------|
| Input Power:            | 95W / 120W / 150W / 200W             |
| Finish Color Options:   | Dark Bronze / White / Black / Silver |
| Nominal Efficacy:       | 140 lm/W max                         |
| CCT:                    | 4000K / 5000K                        |
| CRI Options:            | >70                                  |
| Input Voltage:          | 120-277VAC                           |
| Lifetime Based on TM21: | L70 >147,000 Hrs                     |
| Certifications:         | UL Listed / IP65 / FCC / RoHS        |
| Warranty:               | 5 Years Limited                      |

### CERTIFICATIONS

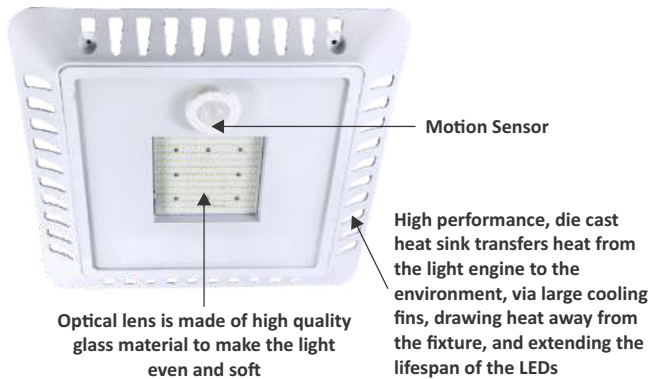

### CONTROLS

- Motion Sensor Mounts in an outdoor lighting fixture and provides multi-level remote controlled motion and/or daylight contribution



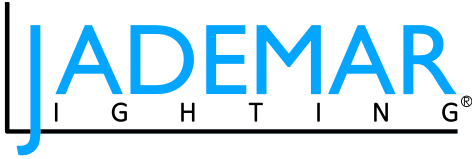

## SPECIFICATION SUBMITTAL DETAIL

|                           |  |              |
|---------------------------|--|--------------|
| <b>Project Name/Type:</b> |  | <b>Date:</b> |
| <b>Catalog/Part #:</b>    |  |              |

**JSD-CP GAS STATION CANOPY LIGHT SERIES**  
 Ordering Information / Example: **JSD-CP-95W-27-40K-WH-BMW**

| Product Series | Wattage                     | Input Voltage                              | CCT                        | Housing Color  | Controls   | Other Options   |
|----------------|-----------------------------|--|----------------------------|--|--|---|
| JSD-CP         | 95W<br>120W<br>150W<br>200W | 27<br><small>(120-277VAC) Standard</small> | 40K (4000K)<br>50K (5000K) | <b>WH</b><br>(White - Standard)<br><br><b>CC</b><br>(Custom Color)<br>*Special Order<br>Please replace "CC" with RAL<br>Color Code | <b>BMW</b><br>(Bi-level microwave<br>occ/motion sensors) | <b>MC6</b><br>(6ft- 3/8" Metal conduit/flex<br>conduit) |

**FIELD INSTALLED OPTIONS**

|           |                           |
|-----------|---------------------------|
| <b>RC</b> | Remote control for Sensor |
|-----------|---------------------------|

**LUMEN PERFORMANCE AND ELECTRICAL DATA**

| Model Numbers                          | JSD-CP-95W                             | JSD-CP120W | JSD-CP150W | JSD-CP200W |
|--|--|------------|------------|------------|
| <b>Nominal Wattage</b>                 | 95W                                    | 120W       | 150W       | 200W       |
| <b>Lumen Output (lm)</b>               | 12,721                                 | 16,086     | 21,250     | 28,390     |
| <b>Average Efficacy (lm/W)</b>         | 130                                    | 130        | 140        | 140        |
| <b>Light Distribution</b>              | 111°                                   | 109°       | 105°       | 105°       |
| <b>Power Factor</b>                    | 0.95                                   | 0.95       | 0.98       | 0.98       |
| <b>CCT</b>                             | 4000K / 5000K                          |            |            |            |
| <b>Input Voltage</b>                   | 120-277VAC                             |            |            |            |
| <b>THD</b>                             | <15%                                   |            |            |            |
| <b>CRI</b>                             | >70 Standard                           |            |            |            |
| <b>Dimming &amp; Controls</b>          | 0-10V Dimming - Motion Sensor Optional |            |            |            |
| <b>Ambient Temperature</b>             | -30°C ~ 45°C (-22°F ~ 113°F)           |            |            |            |
| <b>Outdoor Rating</b>                  | Wet Locations                          |            |            |            |
| <b>Certifications &amp; Compliance</b> | UL Listed / IP65 / FCC / RoHS          |            |            |            |
| <b>Lifetime</b>                        | L70 >147,000 Hrs                       |            |            |            |
| <b>Limited Warranty</b>                | 5 Years                                |            |            |            |

**PRODUCT DIMENSIONS**

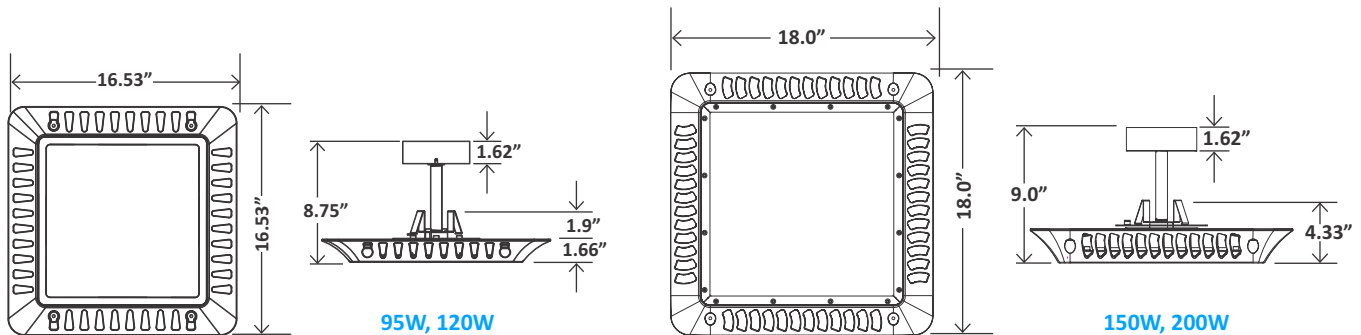

Miami, FL USA - info@jademar.com  
 T: 305.640.0465 - F: 305.640.0468  
**WWW.JADEMAR.COM**



Information contained herein is subject to change without notice.  
 Values are nominal.  
 Revised 09/2022

### JSD-CP95W

LUMINOUS INTENSITY DISTRIBUTION DIAGRAM

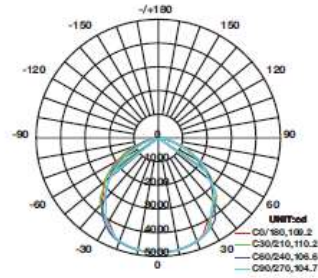

AVERAGE BEAM ANGLE(50%):107.7 DEG

C0 PLANE ISOLUX DIAGRAM (UNIT:lx)

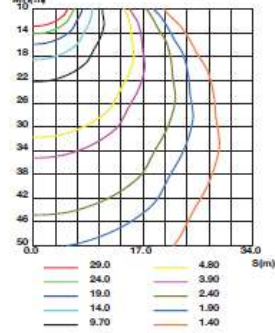

### JSD-CP120W

LUMINOUS INTENSITY DISTRIBUTION DIAGRAM

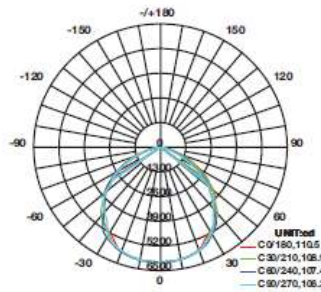

AVERAGE BEAM ANGLE(50%):108.2 DEG

C0 PLANE ISOLUX DIAGRAM (UNIT:lx)

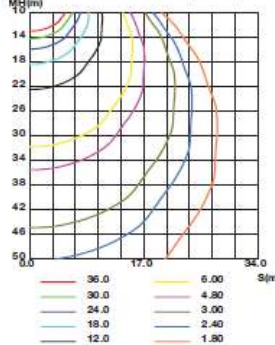

### JSD-CP150W

LUMINOUS INTENSITY DISTRIBUTION DIAGRAM

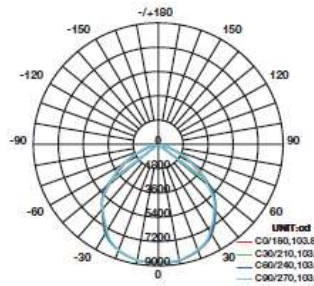

AVERAGE BEAM ANGLE(50%):103.8 DEG

C0 PLANE ISOLUX DIAGRAM (UNIT:lx)

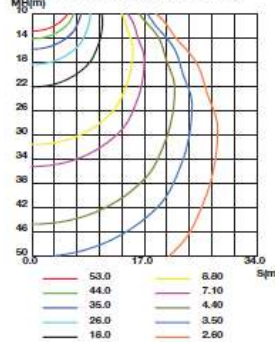

### JSD-CP200W

LUMINOUS INTENSITY DISTRIBUTION DIAGRAM

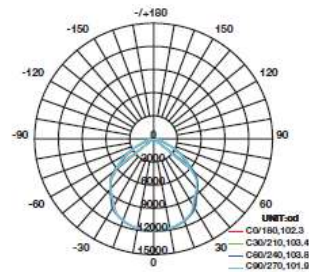

AVERAGE BEAM ANGLE(50%):102.8 DEG

C0 PLANE ISOLUX DIAGRAM (UNIT:lx)

