



JT8-B SERIES

TYPE-B T8 LED GLASS LAMP

Jademar's Type B T8 dual function LED Tube is an excellent replacement for traditional fluorescent T8 lamps.

- Single and Double Sided Power End UL Type B.
- 2Ft-10W and 4Ft-18W 4FT options
- Lumen Maintenance 50,000 Hours
- 5-Year Warranty
- Certifications: UL Listed



3000K / 4000K 5000K



G13



220° BEAM ANGLE

ORDERING INFORMATION

Item Number	Wattage	Length	CCT	Lumen Output	CRI	Beam Angle	Pack Qty	Dimming
JT8-B-2FT-10W-50K-FG	10W	2FT	5000K	1100	>80	>220°	25	NO
JT8-B-4FT-18W-50K-FG	18W	4FT	5000K	2300	>80	>220°	25	NO

LUMEN PERFORMANCE AND ELECTRICAL PARAMETERS

BASE TYPE G13	NOMINAL VOLTAGE 120V-277V	IP RATING IP20	POWER FACTOR >0.9	NON-DIMMABLE	CRI >80	STARTING TIME <1.0 S	LUMEN MAINTENANCE 50,000HOURS	OPERATING TEMP. -20°C ~ +45°C

DIMENSIONS

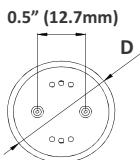
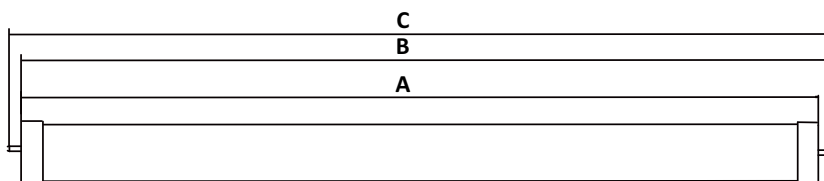

MAXIMUM LENGTH	2FT	4FT
A	23.15" (588mm)	47.17" (1198mm)
B	23.43" (595mm)	47.44" (1205mm)
C	23.74" (603mm)	47.75" (1213mm)

PHOTOMETRICS

2D LIGHT INTENSITY DISTRIBUTION CURVE

Plane [50% Ang.] [10%Ang.]

C0.0: 270.6 353.0

POLAR GRAPH

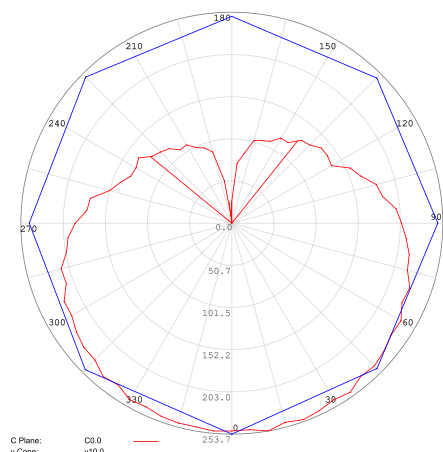

C Plane: C0.0
y Cone: y10.0

Information contained herein is subject to change without notice.

Values are nominal.

Revised 11/2022

Page 1 of 3



INSTALLATION DIAGRAM

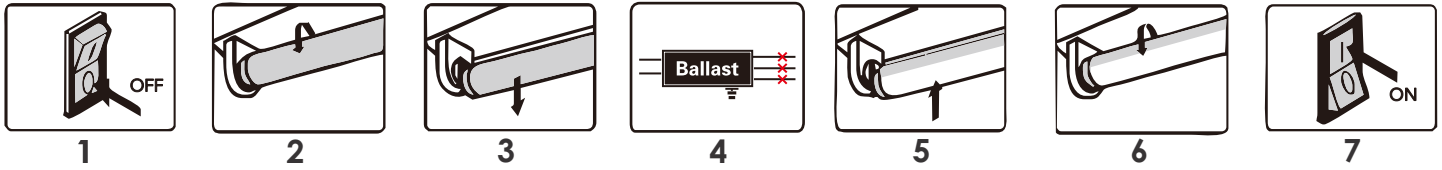

1. Turn off the power.
2. Remove diffuser (if provided).
3. Remove the fluorescent tubes. Please dispose of these items properly as they contain mercury
4. Cut the wires as shown in the diagram.
5. Make the new wire connect to branch circuit as shown.
6. Replace the cover over the wiring chanel.
7. Install the led tubes, close the diffuser.
8. Turn on the power

WIRING DIAGRAM

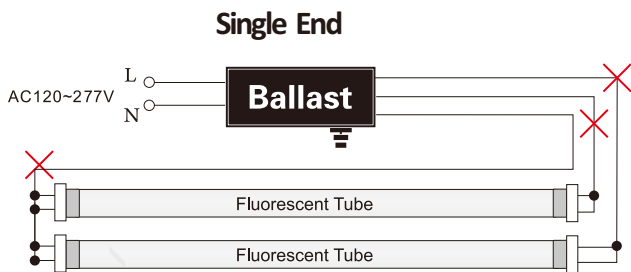

Before

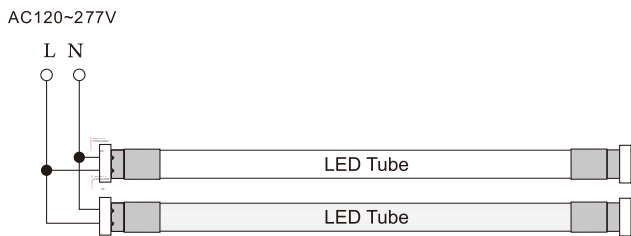

After

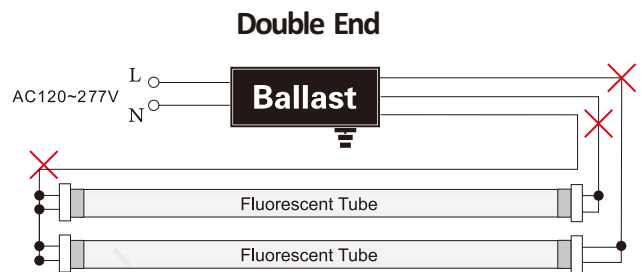

Before

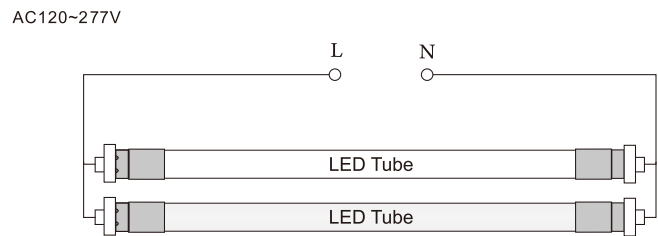

After



1. These lamps should be installed by a licensed electrician.
2. These lamps should be used indoors (damp or dry locations only). Not suitable for wet location.
3. Make sure lampholders are still in good condition and not defected before installation.
4. Put LED tubes/G13 pins into right position of the socket, install properly.
5. This device is not suitable for using with emergency exits.
6. These lamps are not suitable to be used with a light dimmer.
7. If the LED lamp damaged by any one who didn't comply with above warning it releases the manufacturer of responsibility.



Ballasts Compatible List			
No.	Ballast Brand	Model No.	Ballast Start Type
1	ACT	ACT3P32ISUNVE	Instant Start
2	ACT	ATC4P32ISUNVE	Instant Start
3	DAMAR	1688B	Instant Start
4	DAMAR	1688D	Instant Start
5	DAMAR	3654C	Instant Start
6	EIKO	PM-2X32T8-UNV-IS	Instant Start
7	EIKO	PM-3X32T8-UNV-IS-H	Instant Start
8	EIKO	PM-4X32T8-UNV-IS	Instant Start
9	ESPEN	VE2P32MVHIPE 11068	Instant Start
10	ESPEN	VE2P32MVHIPHE 11069	Instant Start
11	ESPEN	VE2P32MVHPPE 11080	Programmed Start
12	ESPEN	VE3P32MVHIPE 11070	Instant Start
13	ESPEN	VE4P32MVHPPE 11086	Programmed Start
14	ESPEN	VE4P32MVHIPE 11072	Instant Start
15	ESPEN	VE4P32MVHIPHE 11073	Instant Start
16	ESPEN	VE432120MIP	Instant Start
17	GE	GE132MAX-G-347	Instant Start
18	GE	GE-132-MV-N	Instant Start
19	GE	GE132MVPS-H	Programmed start
20	GE	GE132MAX-H/Ultra	Instant Start
21	GE	GE240PS-MV-N	Programmed start
22	GE	GE232-120RES-B	Instant Start
23	GE	GE259MAX-G-N	Instant Start
24	GE	GE232-MV-N	Instant Start
25	GE	GE232MAX-G-N	Instant Start
26	GE	GE232MAX-G-N-DIYB	Instant Start
27	GE	GE259MAX-G-N-DIYB	Instant Start
28	GE	GE332MAX-G-N-DIYB	Instant Start
29	GE	GE332MAX-G-H	Instant Start
30	GE	GE332MAXP-H-42T	Instant Start
31	GE	GE432MAXP347-N	Instant Start
32	GE	GE432MAX-G-N	Instant Start
33	GE	GE432MAXP-H/ULTRA	Instant Start
34	GE	GE432MAXG-N-DIYL	Instant Start
35	HALCO	EP232IS/MV/HE	Instant Start
36	HALCO	EP432IS/MV/MC/HE	Instant Start
37	HALCO	EP432ISUNVE	Instant Start
38	HOWARD	EP2/32IS/MV/MC/HE	Instant Start
39	HOWARD	EPL2/32IS/MV/MC/HE	Instant Start
40	HOWARD	EPH4/32IS/MV/SC/HE	Instant Start
41	KEystone	KTEB-232-UV-IS-N-P	Instant Start
42	KEystone	KTEB-332-UV-IS-N-P	Instant Start
43	KEystone	KTEB-432-UV-IS-N-P	Instant Start

Ballasts Compatible List			
No.	Ballast Brand	Model No.	Ballast Start Type
44	OSRAM SYLVANIA	QTP 2X32T8/UNV ISN-SC	Instant Start
45	OSRAM SYLVANIA	QHE 2X32T8/UNV ISN-SC	Instant Start
46	OSRAM SYLVANIA	QHE 2X32T8/UNV PSN-MC	Programmed Start
47	OSRAM SYLVANIA	QTP 3X32T8/UNV ISN-SC	Instant Start
48	OSRAM SYLVANIA	QHE 3XLED32T8/UNV ISN-SC	Instant Start
49	OSRAM SYLVANIA	QHE 3X32T8/UNV ISH HT-SC	Instant Start
50	OSRAM SYLVANIA	QHE 3X32T8/UNV PSN-SC	Programmed Start
51	OSRAM SYLVANIA	QHE 4XLED32T8/UNV ISN-SC	Instant Start
52	OSRAM SYLVANIA	QHE 4X32T8/UNV ISN-SC	Instant Start
53	OSRAM SYLVANIA	QTP 4X32T8/UNV ISN-SC	Instant Start
54	PHILIPS	REZ-2S32-SC	Programmed Start
55	PHILIPS	ICN-1P32-N	Instant Start
56	PHILIPS	ICN-2P32-N	Instant Start
57	PHILIPS	IOPA-2P32-LW-N	Instant Start
58	PHILIPS	IOP-2PSP32-LW-N	Programmed Start
59	PHILIPS	IOPA-2P32-N	Instant Start
60	PHILIPS	IOP-2P32-HL-N	Instant Start
61	PHILIPS	IOP-2PSP32-N	Instant Start
62	PHILIPS	IOP-2P59-N	Instant Start
63	PHILIPS	IOPA-3P32-N	Instant Start
64	PHILIPS	ICN-3P32-N	Instant Start
65	PHILIPS	IOPA-4P32-N	Instant Start
66	PHILIPS	ICN-4P32-N	Instant Start
67	PHILIPS	REB-4P32-SC	Instant Start
68	PHILIPS	VEL-4P32-SC	Instant Start
69	PLUSRITE	BAF232IS/MV	Instant Start
70	PLUSRITE	BAF332IS/MV	Instant Start
71	ROBERTSON	ISL432T8HEMV 3P20160	Instant Start
72	ULTRASAVE	UT232347	Instant Start
73	UNIVERSAL	B232IUNVHP-N	Instant Start
74	UNIVERSAL	B232PUNVHE-B	Programmed Start
75	UNIVERSAL	B232IUNVHEH-A	Instant Start
76	UNIVERSAL	B332IUNVHE-A	Instant Start
77	UNIVERSAL	B332IUNVHP-A	Instant Start
78	UNIVERSAL	B332IUNVEL-A	Instant Start
79	UNIVERSAL	B432IUNVHP-A	Instant Start
80	UNIVERSAL	B432PUNVHE-A	Programmed Start
81	UNIVERSAL	B432IUNVHE-A (A0001)	Instant Start
82	UNIVERSAL	B432IUNVHE-A (51376510-D)	Instant Start
83	UNIVERSAL	B432IUNVHE-A	Instant Start

